

## 5. Streetscape and Connectivity Improvements

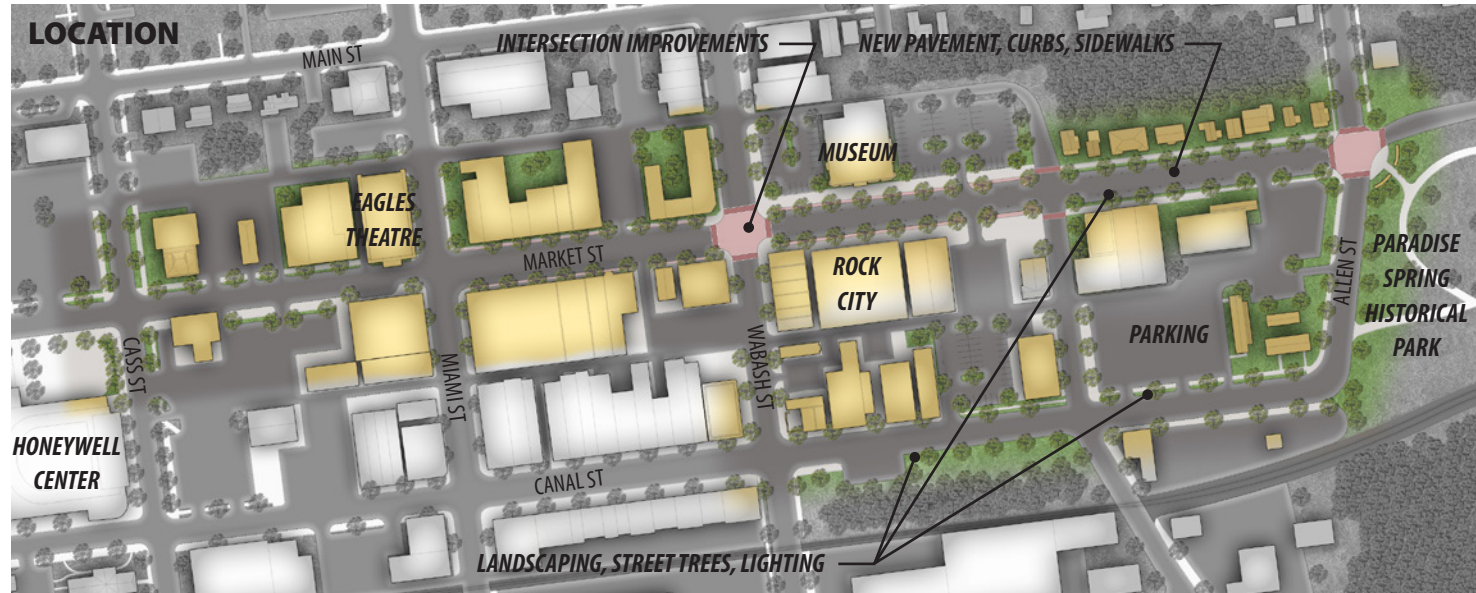

### 5. Streetscape and Connectivity Improvements

#### Project Vision

This project consists of various streetscape and connectivity improvements throughout downtown and throughout the East Market Street District. Streets include Market Street (Miami to Allen), and Canal and Allen Street (Wabash Street to Allen Street to Market Street). This is seen as one integrated project to reduce redundancy in cost and coordination. These improvements will activate underutilized public space and restore aging streetscape through new pavement, curbs, and sidewalks. One-way streets will also be converted to two-way streets for better access and activation of the streets. Pavement markings and signage will be included to accommodate two-way traffic. No signal work is required. Streetscape improvements include decorative crosswalks, landscaping and street trees, and lighting. Other pedestrian amenities like benches and bicycle racks will be installed as part of the Downtown Benches and Bike Racks complementary project. Additional seasonal lamppost banners will be added to existing decorative lights.

**West Market Street: (Miami to Wabash):** This portion consists of sidewalk, curb, and streetscape improvements. The current streetscape has reached its life span. The bricks and sidewalks have shifted and create tripping hazards and pedestrian access issues. The existing trees will be removed as the street trees are suffering and they have outgrown their current space. A better, urban-friendly street tree selection will allow for a longer life of a tree while continuing to provide shade and uniform shape benefits. The improvements in this area include the removal and replacement of the bricks in the buffers – these bricks can either be replaced with stamped and colored decorative concrete, standard unmodified concrete, or a mulched and landscaped planting area. Another streetscape amenity includes decorative crosswalks at each intersection as well as a mid-block crossing to complement the Alley Art Project.

**East Market Street (Wabash to Allen):** This portion consists of milling and resurfacing, sidewalks, and streetscape components. Various asphalt patching (assumed to be 5% of total pavement area) is included. The colored concrete buffer, sidewalks and curbs in this area are in good condition. Sidewalk and curb replacement will occur between South Huntington to Allen Street and will also include ADA accessible curb ramps. This project also includes approach reconstruction for access drives on the south side of Market Street that provides entrances for Wabash Moose Lodge 1195 Family Center. Curbs, decorative lighting, and landscaping will be improved on the north side of the street between Huntington and Allen. On the south side of the street between Huntington and Allen, curbs, lighting, and landscaping will be replaced. The intersection of Market and Allen is critical to improving the connectivity between the amenities downtown and Paradise Spring Historical Park and will have special crosswalks. Bicycle racks were installed in 2013 between Wabash and Huntington. Decorative lighting is also in place between Wabash and Huntington consistent with the rest of downtown Wabash. Sidewalks between Huntington and Allen were replaced in 2012. Preliminary engineering was completed early 2013 for the conversion of one-way to two-way.

**East Canal and Allen Streets (Wabash to Market):** This portion consists of milling and resurfacing from east of Wabash Street up to and including the intersection of East Market Street and Allen Street. Various asphalt patching (assumed to be 5% of total pavement area), sidewalk, curb, ADA accessible curb ramps, and approach reconstruction is included. These improvements will provide a safer, better pedestrian experience to and from amenities near and in the East Market Street District including Paradise Spring Historical Park and Riverwalk Trail access, Moose Lodge, and the complementary project East Market Street Parking Lot Project. With improvement and increased use of this property as a city-owned and sanctioned parking lot, it will get a lot more use and many more visitors will use this corridor.

#### Project Readiness

The City of Wabash completed an extensive ADA Plan (in 2012) that outlines the specific sidewalks and crossing to comply with national standards and improve pedestrian connectivity throughout Wabash. Preliminary engineering is complete for the conversion of one-way to two-way. Wabash Marketplace and the City of Wabash have completed all streetscape improvements as part of the Wabash Public Art Plan. This area would utilize the same design elements and forms as the guidelines for the application of these streetscape projects.

#### Cost Estimate

Total: \$1,921,208  
Committed: \$379,958 (20%)  
Gap / Request: \$1,541,250

#### Priority

High

#### Local Partners

City of Wabash  
Wabash Marketplace, Inc.

### SCHEDULE / COST BREAKDOWN

		2014		2015		2016		2017		2018																					
		M	J	J	A	S	O	N	D	J	F	M	A	M	J	J	A	S	O	N	D	J	F	M	A	M	J	J	A	S	O
5 Streetscape and Connectivity Improvements	Administration (Local/Private)			\$6,995			\$13,989				\$13,989				\$13,989						\$6,995										
	Administration (Gap)			\$-			\$-				\$-				\$-						\$-										
	Design (Local/Private)			\$54,000			\$108,000				\$108,000				\$54,000						\$-										
	Design (Gap)			\$-			\$-				\$-				\$-						\$-										
	Construction (Local/Private)			\$-			\$-				\$-				\$-						\$-										
	Construction (Gap/Private)			\$-			\$-				\$-				\$770,625						\$770,625										
Total Admin: \$55,958	Total Local/Private			\$60,995			\$121,989				\$121,989				\$67,989						\$6,995										
Total Design: \$324,000	Total Gap			\$-			\$-				\$-				\$770,625						\$770,625										
Total Const: \$1,541,250	TOTAL BY YEAR			\$60,995			\$121,989				\$121,989				\$838,614						\$777,620										
<b>\$1,921,208</b>				\$60,995			\$121,989				\$121,989				\$838,614						\$777,620										